

Straightcurve Hardline - Steel

PRODUCT TECHNICAL DATA SHEET

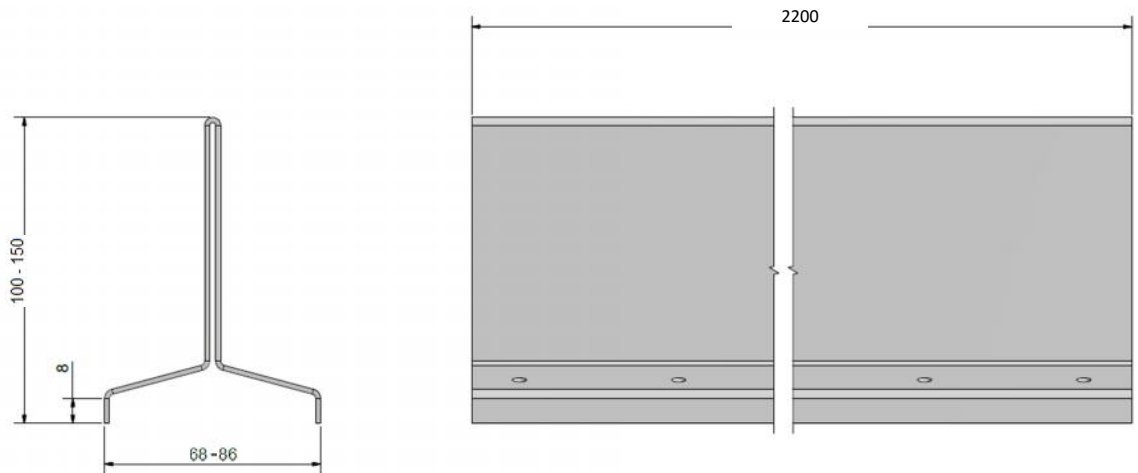

APPLICATION

Straightcurve Hardline is used to make straight lines in gardens or landscapes. It can be used as a barrier between a garden bed and lawn, a feature path, paving edge or as a barrier edge for artificial turf to hold cracker dust in place.

FEATURES

- Stabilising shoulders
- Sloped shoulders for water run-off and extended life span
- Pre drilled holes for ease of use
- Two bottom ridges for optimal securing in ground
- Reinforced join plate for straight connections

TECHNICAL SPECIFICATIONS

Material:	Weathering steel alloy Q345GNHL / Galvanised steel
Finish:	Black (rusts over time) / Powder coated (on request)
Height:	100 mm / 150 mm
Length:	2200 mm
Base width:	68 mm
Thickness:	1.5 mm
Weight:	6.6 kg / 9.9 kg

REQUIRED FASTENERS

Join lengths with Teks screws 10G - 16 mm

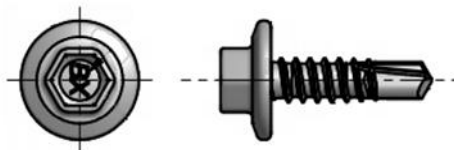

INSTALLATION INSTRUCTIONS

- Start with a flat level base
- Put edges where they need to be
- Join lengths with connector plate with Teks screw
- Use twisted nails to secure the edge in place
- Backfill soil against the edge

NOTE: The strength of this edge is determined by the underlying base. A firm compacted sandy base gives the best result. The edge will shunt or move when placed in loose soils.

CORNERS

A corner can be achieved by making a few cuts with an angle grinder. Cut a piece away from the shoulder, ± 110 degree and cut *one* wall. Make a single cut on the shoulder on the other side as pictured below.

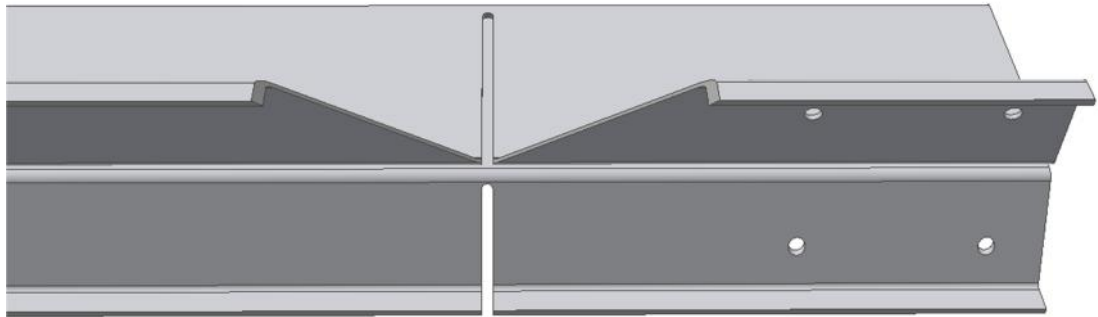

The edge can now bend in a 90 degree angle.

REQUIRED TOOLS

- Rubber Mallet
- Angle grinder
- Cordless drill
- 5/16 Hex Drive

REQUIRED ACCESSORIES

- Straightcurve Hardline Nails, 4 per length

